

Christ & Gantenbein

Projects Office

Christ & Gantenbein AG
Architekten ETH SIA BSA
Spitalstrasse 12
CH-4056 Basel

T +41 61 260 9020
mail@christgantenbein.com
www.christgantenbein.com

Emanuel Christ
Christoph Gantenbein

Partner
Mona Farag

Associates
Tabea Lachenmann
Anna Flückiger
Victoria Easton
Daniel Monheim

Over the past years, a broad range of private and public commissions has given shape to Christ & Gantenbein's growing body of work - encompassing different scales and scopes from individual residential extensions, institutional buildings, infrastructures and urban masterplans. Award-winning projects such as the renovations and extensions to the Kunstmuseum in Basel (2016), the Swiss National Museum in Zurich (2016), as well as the Wallraf-Richartz-Museum in Cologne (ongoing) have strengthened the office's expertise in the development of museum buildings. Housing schemes in Paris and Germany, as well as the Lindt Chocolate Competence Centre in Switzerland are, among others, currently on the drawing board. Founders Emanuel Christ and Christoph Gantenbein, Partner Mona Farag, as well as Associates Tabea Lachenmann, Anna Flückiger, Victoria Easton, Daniel Monheim and Jean Wagner, and about 30 architects staff the practice established in 1998.

Since graduating from the ETH Zurich (Swiss Federal Institute of Technology) in 1998, Emanuel Christ and Christoph Gantenbein have maintained a balance between their profession and academic involvement. After lectureships inter alia at the ETH Studio Basel (2000–2005), the HGK Basel (2002–2003), the Accademia di Architettura in Mendrisio (2004, 2006, 2009) and the Oslo School of Architecture and Design (2008), they returned to the ETH Zurich (2010–2015). Research conducted in this latter period culminated in the meticulous exposition of more than 400 buildings: the two monographs *Typology* (Park Books, 2012, 2015). This compendium further inspires and sustains their on-going occupation with the city and its underlying paradigms. They currently teach at Harvard GSD.

Christ & Gantenbein's work has been distinguished with the best architects 18 Gold (2017), best architects 17 Award – public buildings (2016), the RedDot Award - “Best of the Best” Prize (2016), the Media Architecture Biennale Awards (2016), the Swiss Steel Construction Award - Prix Acier (2014), the ar Award for Emerging Architecture (2009) and two nominations for the Iakov Chernikhov International Prize (2010, 2012).

In 2017 the studio has been invited to contribute to the Chicago Architecture Biennale, the previous year it participated in the 15th Venice Biennale “Reporting from the Front” as well as the 4th Lisbon Architecture Triennial, “The Form of Form”. The work of Christ & Gantenbein is featured in the monographs *a+u 535* (2015), *2G N°68* (2014), *Around the Corner* (Hatje Cantz 2012) and *Pictures from Italy* (Park Books, 2011).

Biographies

Emanuel Christ	Prof., dipl. Arch. ETH SIA BSA
2015–	Visiting Professor at Harvard GSD
2010–2015	Assistant Professor at ETH Zurich
2009/2006	Guest lecturer at Accademia di Architettura Mendrisio
2008	Guest lecturer at Oslo School of Architecture and Design
2005	Guest lecturer at Robert Gordon University Aberdeen
2000–2005	Head of Teaching at ETH Studio Basel
2002–2003	Guest lecturer at Hochschule für Kunst und Gestaltung (HGK), Basel
1999	Travel scholarship to Italy of the Schindler-Stiftung Zurich
1998	Architecture firm in joint partnership with Christoph Gantenbein
1998	Diploma of architecture at ETH Zurich with Prof. Hans Kollhoff
1991–1998	Student of architecture at ETH Zurich, EPF Lausanne and at HdK Berlin
1970	Born in Basel, Switzerland
Christoph Gantenbein	Prof., dipl. Arch. ETH SIA BSA
2015–	Visiting Professor at Harvard GSD
2010–2015	Assistant Professor at ETH Zurich
2009/2006/2004	Guest lecturer at Accademia di Architettura Mendrisio
2008	Guest lecturer at Oslo School of Architecture and Design
2008–	Member of managing board SIA Basel
2002–2003	Guest lecturer at Hochschule für Gestaltung und Kunst (HGK), Basel
2000–2002	Assistant Designer to Axel Fickert at the ETH Zurich
1999	Travel scholarship to Italy of the Schindler-Stiftung Zurich
1998	Architecture firm in joint partnership with Emanuel Christ
1998	Diploma of architecture at ETH Zurich with Prof. Hans Kollhoff
1991–1998	Student of architecture at ETH Zurich
1971	Born in St. Gallen, Switzerland



Biographies

Partner

Mona Farag dipl. Ing.

2017	Partner at Christ & Gantenbein
2007	Associate at Christ & Gantenbein, Basel
2002	Christ & Gantenbein, Basel
2001	Nissen Wentzlaff Architekten, Basel
2000	Diploma of architecture at TU Karlsruhe
1999	VMX Architects, Amsterdam
1993–2000	Student of architecture at TU Karlsruhe and ETSA Coruña
1974	Born in Siegen, Germany

Associates

Tabea Lachenmann dipl. Arch.

2009	Associate at Christ & Gantenbein, Basel
2005	Christ & Gantenbein, Basel
2004	Diploma of architecture at University of Stuttgart
2003–2004	Knapkiewicz & Fickert, Zurich
1998–2004	Student of architecture at University of Stuttgart and EPF Lausanne
1978	Born in Stuttgart, Germany

Anna Flückiger dipl. Arch. ETH

2011	Associate at Christ & Gantenbein, Basel
2008	Christ & Gantenbein, Basel
2006–2007	Thomas Kroeger Architekt, Berlin
2006	Travel scholarship to Brasil of the Erich Degen Stiftung, Zurich
2005	Diploma of architecture at ETH Zurich with Prof. Adrian Meyer
1999–2005	Student of architecture at ETH Zurich
1979	Born in Samedan, Switzerland

Victoria Easton dipl. Arch. ETH

2012	Research Associate at Christ & Gantenbein, Basel
2010	Assistant to Emanuel Christ and Christoph Gantenbein at ETH Zurich
2008–2009	Assistant to visiting professor Jean-Paul Jaccaud at EPF Lausanne
2005–2008	Christ & Gantenbein, Basel
2005	Christian Penzel Architekt, Zurich
2005	Diploma of architecture at ETH Zurich with Prof. Peter Märkli
1999–2005	Student of architecture at ETH Zurich
1981	Born in Lausanne, Switzerland

Daniel Monheim dipl. Arch.

2017	Associate at Christ & Gantenbein, Basel
2011	Christ & Gantenbein, Basel
2006	Diploma of architecture at ETSA Barcelona with Prof. Carles Ferrater and Prof. Daniel Kündig
2005	International and interdisciplinary project 'POLE Europe' at UAS Aargau and ETSA Barcelona
2000-2006	Student of architecture at BTU Cottbus, TU Darmstadt and ETSA Barcelona
1998-2000	Education as a carpenter in Cologne
1976	Born in Cologne, Germany

Jean Wagner MSc. EPFL

2017	Associate at Christ & Gantenbein, Basel
2009	Christ & Gantenbein, Basel
2009	Trinkler Stula Achille Architekten, Basel
2008	Master's Degree of Architecture at EPF Lausanne with Anne Lacaton, Prof. Roberto Gargiani and Pierre Chuard
2001-2007	Student of architecture at the EPF Lausanne
1983	Born in Dijon, France

Team

Founding Partners

Emanuel Christ
Christoph Gantenbein

Partner

Mona Farag

Associates

Tabea Lachenmann
Anna Flückiger
Victoria Easton
Daniel Monheim
Jean Wagner

Architects

Andrea Benincasa
Arthur Clauss
Ana Sofia Costa Guerra
Thibaut Dancoisne
Eileen Eckart
Szabolcs Egyed
Moisés García
Cloé Gattigo
Astrid Kühn
Alessandro Luraschi
Andrew Mackintosh
Luise Marter
Julian Meisen
Stephanie Müller-Wamister
Edward Nicholson
Catia Polido
Anette Schick
Robert Schiemann
Anne-Katharina Schulze
Julia Tobler
Leandro Villalba
Jean Wagner
Leonie Welling
Christina Wendler
Kristin Widjaja
Jan Zachmann
Diana Zenklusen

PR & Communication

Claudia Di Lecce

Administration

Barbara Dähler
Anita Grieder
Fabienne Koitka
Yaël Widmer

Awards + Academic Activities + Publications

Awards (selection)

- 2017 • BETON 17 Award, Cemsuisse, Honorable Mention, Extension Swiss National Museum, Zürich
- «best architects 18 Award», Extension Swiss National Museum, Zürich (Gold) and High-rise at the Station, Pratteln, CH
- 2016 • «best architects 17 Award», Kunstmuseum Basel and List Customer Center, Arisdorf, CH
- «Essence Award - Gold Prize», Kunstmuseum Basel
- «RedDot Award - Best of the Best», Kunstmuseum Basel
- 2014 • «Schweizer Stahlbaupreis Prix Acier 2014», Pedestrian Bridge Birsikopfsteig, Basel
- 2013 • «Die schönsten deutschen Bücher 2013», Review n°II: Typology
- «Auszeichnung Guter Bauten 2013», VoltaMitte, residential and commercial building Basel, Commercial Building at Bahnhofplatz Liestal, CH, Park-Café in the Elisabethenanlage, Basel, and Pedestrian Bridge Birsikopfsteig, Basel
- «best architects 14», VoltaMitte, residential and commercial building, Basel, Commercial Building, Liestal, CH and Pilgrim's Column, Jalisco, MX
- 2012 • «Iakov Chernikhov International Prize», Nomination
- «arc award», Nomination, VoltaMitte, residential and commercial building, Basel
- «World Architecture Festival», Shortlisted, Commercial Building, Liestal, CH
- «AIT Award», Nomination, commercial building, Liestal, CH and Roche Office and Technical Building, Grenzach, DE
- 2010 • «Iakov Chernikhov International Prize»,
- 2009 • «ar Award for Emerging Architecture», The Architectural Review, Renovation Swiss National Museum, Zürich, CH, and Ancient Tree, Jinhua, China
- 2008 • «Auszeichnung Guter Bauten 2008», Haus am Bildstöckliweg, Arlesheim, CH
- 2006 • «Basler Heimatschutz – Verdienste um die Basler Baukultur» Shedhalle in the St. Alban-Vorstadt, Basel
- 2005 • BETON 05 Award, Cemsuisse, Haus am Bildstöckliweg, Arlesheim, CH
- 1999 • Travel scholarship to Italy of the Schindler-Stiftung Zurich

Academic Activities (selection)

- 2016 • Option Studio The Art Space, Harvard GSD, Cambridge, USA
- Oxford Archeology, The Architecture Foundation Masterclass, Oxford, UK
- Porto Archeology, Porto Academy, Porto, PT
- 2015 • Modern Cities – Réinventer Paris, ETH Zürich
- Heritage #5: Mailand, Il Mercato Ortofrutticolo, ETH Zürich
- Option Studio Building for Fashion, Harvard GSD, Cambridge, USA
- 2014 • Heritage #4: Brüssel, Bassin Vergote, ETH Zürich
- Heritage #3: Basel Rheinhafen, ETH Zürich
- 2013 • Heritage #2: The Postindustrial City, ETH Zürich
- Heritage #1: The Great Potential, ETH Zürich
- 2012 • Typologietransfer #6: Learning from Paris, ETH Zürich
- Remaking Zurich, 5th International Architecture Biennale Rotterdam «Making City», Rotterdam, NL
- 2011 • Typologietransfer #5: Collage City, ETH Zürich, FS, 2011
- 120% Brussels, International Master Class mit Christ & Gantenbein und OFFICE Kersten Geers David Van Severen, Architecture Workroom Brussels, Brüssel, BEL
- Typologietransfer #4: Buenos Aires in Zürich, ETH Zürich
- Typologietransfer #3: New York in Zürich, ETH Zürich
- 2010 • Typologietransfer #2: Rom in Zürich, ETH Zürich
- Typologietransfer #1: Hong Kong in Zürich, ETH Zürich
- 2009 • Grand Hotel, Accademia di Architettura Mendrisio
- Big House, Accademia di Architettura Mendrisio
- 2008 • Big House, Oslo School of Architecture and Design
- 2006 • Dream House II – La Torre, Accademia di Architettura Mendrisio
- 2004 • Dream House I, Accademia di Architettura Mendrisio

Publications (selection)

- 2017 • Emanuel Christ and Christoph Gantenbein, The Art Space, Cambridge, Massachusetts : Harvard GSD
- 2016 • Emanuel Christ and Christoph Gantenbein, More than a Hundred Years, Basel : Christ & Gantenbein
- 2015 • Emanuel Christ and Christoph Gantenbein, ETH Zürich, Paris, Delhi, São Paulo, Athens, iPhone- App, 2015
- Emanuel Christ, Christoph Gantenbein, Victoria Easton, Cloé Gattigo, ETH Zürich (Eds.), Review N°III: Typology – Paris, Delhi, São Paulo, Athens, Zürich : Park Books
- 2014 • Emanuel Christ and Christoph Gantenbein, Stadtfabrik – Entwürfe zur Urbanisierung der ehemaligen Papierfabrik Biberist, Zürich : ETH Zürich
- 2013 • Baumeister: curated by Christ & Gantenbein, Baumeister B8, 08.2013
- 2012 • Emanuel Christ and Christoph Gantenbein, ETH Zürich, Hong Kong, Rome, New York, Buenos Aires Typology City Guide, iPhone- App
- Emanuel Christ, Christoph Gantenbein, Victoria Easton, ETH Zürich (Eds.), Review N°II: Typology – Hong Kong, Rome, New York, Buenos Aires, Zürich : Park Books, 2012
- 2011 • Emanuel Christ and Christoph Gantenbein, Review N°I: Pictures from Italy, Zürich : Park Books
- 2010 • Emanuel Christ and Christoph Gantenbein, ETH Zürich (Eds.), Hong Kong Typology, Zürich: Gta Verlag

Projects

Kunstmuseum Basel Extension Basel, Switzerland

size	11'481 sqm
building costs	100 Mio CHF
competition	2010, 1st prize
project	2010–2012
construction	2012–2016
client	Basel-Stadt Canton



The extension functions as the contemporary counterpart to the Kunstmuseum's main building from the 1930s. The north-west façade flexes into an indented corner, providing a welcoming entrance that spatially refers to the straight arcade of the pre-existing structure. With skylights at the top and windows in the middle, the organization into three floors is inspired by the main building's typology. The façade in water-struck grey bricks also perpetuates the compactness of its light limestone volume. A light frieze subtly merges text elements within the brick layers. Delineated by loadbearing concrete walls in a cross lay-out, the new exhibition spaces convey permanence while leaving the staircase to modulate the resulting areas.

Swiss National Museum Extension Zurich, Switzerland

size	7'400 sqm
building costs	111 Mio CHF
competition	2002, 1st prize
project	2006–2010
construction	2012–2016
client	Swiss Confederation, represented by the Bundesamt für Bauten und Logistik



The new wing of the Swiss National Museum forms a ring that by completing the existing U-shaped building proposes a new path within the museum itself. The extension includes flexible exhibition spaces, a public library and a spacious auditorium. Spanning across the wide space connecting the newly created inner courtyard with the park, the bridge constitutes the leading architectural gesture of the project. The roof landscape of the extension refers to the wild pitched-roofs composition of its neo-medieval predecessor. The strong stone walls of the 19th-century building are echoed in the new wing's thick walls, which fulfil the high thermal insulation requirements of the Minergie-P Eco standard. As different as the two buildings are, their shared attributes are apparent and manage to seamlessly create a unity of old and new.

Apartment and Office Tower Pratteln, Switzerland

size	18'150 sqm
building costs	approx. 42.5 Mio CHF
competition	2007, 1st prize
project	2009–2012
construction	2013–2016
client	Balintra AG, represented by UBS Fund Management (Switzerland) AG



Erected on Pratteln's train station square, the high-rise building is composed of two main parts. The first is a podium that providing spaces for offices and retail, extends with its two cantilevering wings in a welcoming gesture towards the station. Rising on this socle is a 20-storey tower with 76 apartments. The fan-shaped floor plans of the apartments expand southwards from the northern access core. The result of very pragmatic studies to reduce the noise disturbance occasioned by the nearby railway, the silhouette of the high-rise serves as a captivating landmark in the city's skyline. The polished metallic skin of the façade emphasizes the building's sharp contours and embeds it within its industrial surroundings.

List Customer Center Arisdorf, Switzerland

size	2'704 sqm
feasibility study	2011, 1st prize
project	2011–2012
construction	2013–2015
client	List AG Switzerland



The List Customer Center capitalises on its situation to provide visitors with an insight into the charm of Swiss nature while presenting high-end chemical processes. The building quotes industrial architecture while the use of specifically developed architectural artefacts reflects the high expectations of the unique and precise industry the construction sets out to represent. Six load-bearing walls are entrenched within the subtle slope to build up the basement, spreading like a fan and taking advantage of the plot's form. Shed roofs allow the daylight into the depth of the building. The façade is clad with a 3-mm thick, sanded large-scale raw aluminium sheet, recalling a well-polished turbine.

Lindt Chocolate Competence Center Kilchberg, Switzerland

size	21'540 sqm
competition	2014, 1st prize
project	2015–
client	Lindt Competence Center Foundation



The Lindt Chocolate Competence Center provides a wide range of different activities such as a training centre for chocolatiers, a research department, a Chocolate Museum Experience Center with multimedia presentation as well as a Chocateria where visitors will be able to have a go at making their own chocolate. All these different experiences are linked by means of round staircases and ramps crossing the three-floor high atrium. A concave façade of of red and white enameled bricks welcomes the visitor and opens towards a new public space.

Projects

Opération Vaugirard Social Housing Paris, France

size	7'700 sqm
competition	2014, 1st prize
project	2014–
client	Logis Transports (RATP)



A large industrial block in the midst of Paris is to be densified upon the restructuring of some metro's maintenance workshops. 104 social housing apartments sit on top of a refurbished base with workshops. The 124 m long volume blends in within the traditional Haussmannian street profile, but is enhanced by five «redents» (stepped alignments) which provide multiple orientations to the apartments. The latter are compact and efficient but combined with generous outside spaces. The façade, the sharp edges and the repetition of a single type of window are as much a reference to industrial architecture as a pragmatic answer to a limited budget.

Wallraf-Richartz-Museum & Fondation Corboud Extension Cologne, Germany

size	5'294 sqm
competition	2013, 1st prize
project	2013–
client	City of Cologne and Stifterrat Wallraf-Richartz-Museum & Fondation Corboud



The new volume confidently stands next to the existing institutional building built by O.M.Ungers. It provides a new architectural expression to art mediation without assigning a completely new identity to the museum. Relating to some neighbouring brick buildings, the façade's brickwork subtly answers to Ungers' natural stone façade. Split into columns, the base opens up to the city while lifting the building out of the ground. New stairs lead from the existing building's entrance hall into the new basement. Organised on three floors, the exhibition spaces are characterised by clear proportions and simple materials, in order to offer classical rooms for art.

Postareal Liestal Housing and Retail Development Liestal, Switzerland

size	17'878 sqm
competition	2016, 1st prize
project	2016 –
client	Post Immobilien Management & Services AG, Stadt Liestal

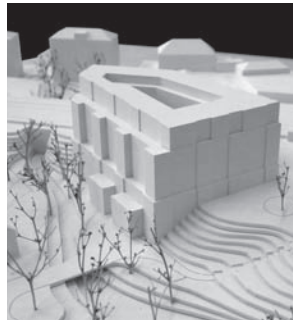

A housing and retail development stands in a dramatic topography between the old town and its modern counterpart. A scenic river runs along the land slope and provides natural leisure areas in the vicinity. The courtyard type building is compact and strives at urban density, while fulfilling all standards of protection to the strong noise-exposition, as well as providing all apartments with appropriate sun-orientation. The high podium adapts to the strong topography and thus provides two ground-floors welcoming mixed activities. A translucent façade of glass and glass-bricks help the massive volume to get a lighter appearance while seen from the old town.

Bridge on the Aare River Aarau, Switzerland

length	110 m
building costs	approx. 20 Mio CHF
competition	2010, 1st prize
project	2010–
client	Kanton Aarau



The structure of an old chain bridge in Aarau has suffered from decades of applied load. The new bridge is blending harmonically into the historic town setting and at the same time creates an attractive layout by the waterside. The formal principle of the bridge recalls the continuity of the historic fabric: plinths of houses, city walls, breast walls and ramps. The building links the city's traffic network with the varying topography. The existing piers are absorbed within the three arches, while two new piers are added along both riverbanks.

SäliRAIN Garden Apartments Solothurn, Switzerland

size	1280 sqm
invited competition	2016, 1st prize
project	2016 –



Situated right next to Castle Blumenstein, the new building lies in a stepped landscape and acknowledges the historical dimension of its Baroque gardens. A modern ideal of housing is realised by emphasizing the relation between interior spaces and nature. The multi-family home proposes five ground-floor apartments extending into the gardens by means of a pergola, and five duplex apartments growing into the roof and reaching for a view of the Alps. The subtle wooden skeleton stacks two pergolas on top of each other and thus further links the building to the garden. The red lacquered wood relates to the neighbouring castle's window shutters and contrasts with the garden's luscious green.

Projects

Obere Schiedhalde Lux-Guyer Haus Küsnacht, Switzerland

in collaboration with	Sven Richter
size	398 sqm
project	2012
construction	2012 – 2014



The „Obere Schiedhalde“ house was built by Lux Guyer in 1929 as a variation of her prefabricated house developed for the SAFFA (Swiss Exhibition of Female Labour, 1928). The original building has been mostly kept and thoroughly refurbished. Details, or characteristic spaces have been reconstructed according to the original plans and photographs. Meticulous research has been invested in the reconstruction of colour schemes as well as materiality. Today, the house fulfils the needs of a young family, as well as the requirements of historic preservation.

Swiss Pavilion Wittenberg, Germany

size	200 sqm
exhibition	2017
curators	Juri Steiner, Gabriel de Montmollin
client	SEK-FEPS



The pavilion celebrates the history of Swiss Protestantism on the occasion of the 500th anniversary of the Reformation, taking place in 2017 in Wittenberg, Germany. The pavilion lies in a longish site in a park and unfolds in a series of four spaces, one of which contains the reproduction of a Gutenberg press. The simple structure reflects on the primary dwelling: a trivial shelter which mediates between “homeness” and holiness, while suggesting a place of production like a factory or a sawmill. The exhibition spaces are enclosed within the white wooden structure by means of heavy fabric tainted in Holbein and Cranach colours.

Westhof Housing and Commercial Building Munich, Germany

size	13'000 sqm
competition	2011, 1st prize
project	2011–
client	Pandion AG



The former post office, a listed historic building from the 1920s, situated in the West of Munich's city centre, is to be transformed for new functions. The existing typology – a perimeter block surrounding three functional buildings – is complemented with a lateral construction. The recessed new building separates the site of almost 6'000 sqm into a private courtyard and an open front court. The house can be furnished flexibly with different housing typologies from one- to five-room apartments. The slight slant of the seven-storey volume refers to the formal language of the existing architecture and enables a broad lightening of the courtyards within a high-density development.

Museum des 20. Jahrhunderts Berlin, Germany

size	28'217 sqm
competition	2016
client	Stiftung Preussischer Kulturbesitz

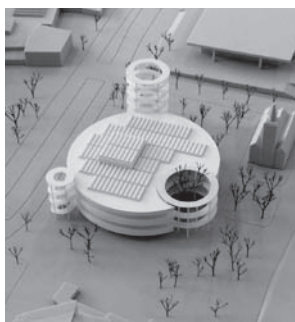

The 20th Century museum has neither a front, nor a back. It has no central staircase, no predefined paths. It is a cosmos, large and complex. It is round to allow the visitors to dive into the art world from different perspectives. The exhibitions inhabit the protected centre of the building, a layer with multiple activities wraps around them and opens itself to the city. The structural grid provides 10 m wide spatial layers which can be divided by means of flexible partitions. A round atrium shelters the historical plane tree and brings light into the depth of the building. The ground-floor is completely open to the city, follows the natural slope of the site, and offers a platform to different activities.

Alte Akademie Redevelopment München, Germany

size	29'415 sqm
competition	2016, 2nd prize
client	Alte Akademie Immobilien GmbH & Co. KG (SIGNA Group) in coordination with Landeshauptstadt München



In Munich's city centre, the Hettlage shopping mall built by Wiedemann in the 1950s and a Jesuit Collegium in Renaissance and Baroque style are to be refurbished and transformed. How should city-centres built over centuries be enrolled and adapted to contemporary urbanity? Museification cannot be a goal: our time shall manifest in historical architecture by means of subtly built adaptations. It is about continuity and transformation. For example, some windows of the shopping mall are closed off with marble plates in order to allow the adaptation of the floor plates to the Jesuit Collegium. Or a dark shopping arcade is transformed into a passage-hall thus welcoming new activities.

Projects

Pompeii and the Greeks Exhibition Design Pompeii, Italy

invited competition	2016
in collaboration with	Valter Scelsi, Genova
client	Electa Mondadori, Art, Exhibitions and Museums

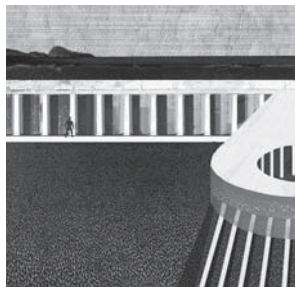

The exhibition aims at presenting the different Greek souls of Pompeii, and in doing so to reveal the complexity of an architectural narrative. The exhibition design unfolds along the Palestra's West portico, as well as within a provisory structure occupying the centre of the gymnasium. The temporary round water theatre embodies the important caesura within Pompeii and Napoli's history, the battle of Cumae in 474 BC.

MUDAC Museum Lausanne, Switzerland

size	19'000 sqm
competition	2015
client	Departement des finances et des relations exterieures - service immeubles, patrimoine et logistique

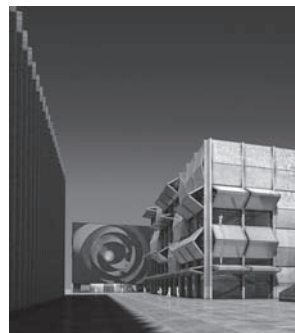

The three museums Mcb-a, Elysée and Mudac stand as three distinct volumes: the Mcb-a displays a colonnade, the Elysée suggests a camera obscura in dark brick, the Mudac evokes a dynamic object whose façade changes according to each exhibition. The Mudac and Elysée are exclusively dedicated to exhibitions: this influences the typology of both buildings. The load-bearing structure and floor height are optimised to offer large spaces. In the Mudac, space itself serves as a display of the objects, with a view onto the city and the landscape in option, while in the Elysée, the display of photographs happens on the walls, into which only rarely a window is cut out.

Bauhaus Archive Berlin, Germany

size	7'499 sqm
competition	2015
client	Senatsverwaltung für Stadtentwicklung und Umwelt



The two main functions of the institution, archiving and showing, are decisively separated: the archive rises to the sky, while the exhibition is buried into the ground. In between, lies the new entrance. The Bauhaus Archive thus regains its presence within the city, formerly lost because of urban renewal in the vicinity. The façade of the archive box is developed as a textile work, for example from pioneer Gunta Stözl, following the Bauhaus tradition of "united arts". Gropius' building delicate appearance, as well as its formal principles such as composition and partial symmetry, are reflected into the new building, thus allowing for a dialogue between old and new.

Accademia d'Architettura Student Workshops Mendrisio, Switzerland

size	2'997 sqm
competition	2015
client	USI - Accademia di architettura



The Mendrisio campus is made of archetypes: the villa, the palazzo, and the church form a group of public buildings with archetypical value. The First Year House expands this collection by adding one further type: the primitive hut. It recalls a simple agricultural structure, a tobacco drying kiln, or the porticoed barn of a venetian villa. It provides luminous spaces onto two floors, one of both, under the roof. Indeed it is just a façade and a roof: the concrete structure offers flexible spaces, lit from both sides. The staircase is positioned outside of the volume and operates as a stiffening core, while allowing for the needed flexibility of the spaces.

Biomedical Laboratory Basel, Switzerland

size	31'831 sqm
competition	2015
client	University of Basel, represented by the Hochbauamt Basel-Stadt



Pharmazentrum and the department of Biomedicine are merged into one single building. Instead of the common hermeticity of such laboratory and research infrastructure, the new building aims at openness. Two entrances, linked by a common foyer, make the building porous and the open laboratories, seminar rooms, and lecture halls on the ground floor, provide the street level with an almost public interior space. Even the laboratories open themselves: a big terrace, a loggia with outdoor working spaces, and a vertical garden, allow the researchers to exit the building. There, the façade becomes three-dimensional, a space frame builds multi-storey rooms.

Projects

Swiss Life Housing Towers Zürich, Switzerland

size	24'326 sqm
competition	2015
client	Swiss Life REIM (Switzerland) AG



Two similar towers of different heights spatially and physically relate to each other. Rental apartments occupy the higher tower (57 m), while condominiums fill the lower one (40 m). The double figure – emphasized by the similar architectural treatment of the façade – expounds a common topic within the Swiss suburban tower-landscape. A café and a restaurant on the ground floor, as well as ateliers on the first floor provide a mixed-use base with high urban potential thanks to its extra-high windows. Most of the apartments occupy a corner and thus enjoy a double façade orientation, which results into a strong spatial diagonal.

Givaudan Innovation Center Kemptthal, Switzerland

size	19'607 sqm
feasibility study	2013 – 2014
client	Givaudan Schweiz AG, Site Kemptthal



In a site famous for its industrial heritage, the new Givaudan innovation centre gathers offices and laboratories for the leader in flavour and fragrance industry. Vertical brick pillars structure the façade following the rhythm of the laboratory units and provide a certain depth to the envelope: they convey firmness and openness. The bricks' yellowish tone establishes a relationship to the site's historical architecture. Limited depth of the building allows the office spaces to stay in the vicinity of the laboratories while enjoying the great view onto the surrounding landscape. Flexibility and adaptation in the laboratories are guaranteed according to contemporary standards and by means of multiple devices.

Innovation Campus Aesch, Switzerland

size	10'000 sqm
direct assignment	
project:	2014 –
client	HIAG Immobilien



The project foresees the conversion of an industrial hall into a medical technology research facility. The traditional shed-roof hall is stripped to its primary structure and allows for a free appropriation of the spaces, thus emphasizing a multi-disciplinary exchange. The long strips finish onto a luscious green and are extended into outdoor spaces. In the long term, the complex is to be extended by five additional buildings, which can dock to the large hall, turned into a generous linking infrastructure.

Zwicky Apartment High-Rise Wallisellen, Switzerland

size	25'642 sqm
competition	2014, 2nd prize
client	Halter AG Entwicklungen



The housing tower is situated in a heterotopian man-made landscape between transport infrastructure and a left-over piece of forest. The faceted free-standing building engages in a spatial and physical relation with its surroundings: the offsets interlock with the environment and form four vertical entrance façades orientated towards a new square. The slightly curved silhouette shimmers through the bluish ceramic tiles of the façades' horizontal parts, while cast-stones clad the vertical elements. The 75 m high volume fans out against the highway situated at the northern end of the site and thus provides efficient noise-control conditions. Analogue to the façade, faceted living-spaces span from one façade to the other, building niches and reaching up to the south-loggia.

Triptych A house for the Isle of Harris Scotland, UK

size	403 sqm
exhibition	2014
client	AE Foundation



The small house is inhabited by an artist couple together with their family. The spaces allow them to pursue their artistic work, or organise workshops with their students. Set between a house and a studio, the courtyard takes a central space, protected from the constant wind, the wide sky as its only roof. Three large windows frame the view onto the sea. The building's simple steel structure is faced with corrugated sheets outside and with wood inside. The project re-interprets the Scottish rural architecture as the goal of contemporary nomadism. The design was developed for an exhibition displaying new homes for residents living in an isolated environment.

Projects

Galerie Bob van Orsouw Stand at ART Basel Basel, Switzerland

direct assignment	
project	2014
construction	2014
client	Galerie Bob van Orsouw



The architectural concept for this ART Basel booth puts in context the exhibited works. As colours feel more intense and art looks more dramatic onto a dark background, the walls were covered with a greyish brown lime-cement plaster. Instead of a common table, a simple sanded concrete bench laconically stands along a wall of the booth and thus confirms the space as what it obviously is: a public space.

Musée du Léman Extension Nyon, Switzerland

size	5908 sqm
competition	2014
client	City of Nyon



The two pitched-roof volumes align next to the old museum mansion. The visitor directly relates the exhibits to their context thanks to the fully glazed façades which allow for an undisturbed view onto the lake. The expressive wooden structures remind of lakeside boat infrastructure and are clad with special local glass bricks.

Villa Maraini Refurbishment Rome, Italy

size	602 sqm
competition	2013, 3rd prize
client	Bundesamt für Bauten und Logistik



The renewal of the institution happens through a playful appropriation of the existing which thus receives a memorable address. The project defines a new entrance to the Istituto Svizzero through the baroque grotto, which lies in the axis of the entrance gate and above which the villa is enthroned. The visitor arrives into a new underground foyer which is also a multipurpose space from which a new monumental stair leads to the ground floor of the villa. The bedrooms of the classical villa are transformed into neutral spaces with minimal technical installations which can be flexibly attributed and thus able to welcome different types of living scenarios for artists and researchers.

Zürich-Oerlikon, Südwest Mitte Office Building Zurich, Switzerland

size	22'934 sqm
competition	2013
client	SBB AG



The elegant slab along the railway tracks is a striking solitary silhouette despite the modesty of its architectural means. The building is anchored in the city through its three-floor high base. It relates to the dimension and the typology of the neighbouring station buildings while the tower sets a sign at the scale of the tracks and within the wide landscape. The curtain-wall façade is clad with aluminium.

Garden Pavilion Basel, Switzerland

size	70 sqm
direct assignment	
project	2011
construction	2012



A small box sits at one corner of the extensive garden of a 1930s villa. Like a camouflage infrastructure in the garden, the pavilion's wooden structure is homogeneously covered by a grey-green roofing-paper laid following a precise panel arrangement. A series of large vertical windows are punched out of the flat, undecorated facade. The windows can be closed by means of large shutters which allow to completely obscure the pavilion. Inside, an enfilade of three main compartments is reminiscent of a bourgeois interior. Two square living spaces are symmetrically arranged on each side of the core, providing a bathroom and a kitchen.

Projects

Areal Schärer Apartments and Shops Erlenbach, Switzerland

size	8'715 sqm
building costs	27 Mio CHF
feasibility study	2005
project	2008–2009
construction	2010–2012
client	Schärer Erlenbach AG



The five-storey housing development is composed of shops on the ground floor and apartments on the upper floors. With its anthracite-coloured wooden façade it is related to the former Schärer factory building in terms of scale, the composition of the façade and the large banks of windows. Its structure reacts to the surroundings, to the location's quality of light, view and space with individual floor plans for each apartment, from compact to elongated, from winding to sprawled out and to maisonettes. None of the 13 apartments is alike and thanks to the graded stacking of volumes there are generous terraces on every floor.

Office Building Liestal, Switzerland

size	9'660 sqm
building costs	28 Mio CHF
feasibility study	2004
project	2007–2009
construction	2009–2011
client	Basellandschaftliche Kantonalbank



The six-storey office building occupies a triangular site between the train station and the client's head office. Due to the constrictions of the site the building's footprint is smaller than its upper storeys, resulting in a downward tapering shape. The anthracite-coloured concrete conveys a sense of robustness and stability at this dynamic location. Towards the station side, the façade is cut out to open up to a generous canopied area, providing a roof for shoppers on the ground floor level. A modular façade grid embraces the building's top floors and traces the volume's distortion at the bottom. Each façade panel relates to an office axis inside and forms a small oriel.

Roche Technical and Office Building Grenzach, Germany

size	6'900 sqm
building costs	20 Mio EUR
competition	2008, 1st prize
project	2008–2009
construction	2009–2011
client	Roche Pharma AG



A new office building and an affiliated technical building are added to the Roche Campus, the pharmaceutical company's headquarters in Grenzach. Both are oriented towards the middle of the campus and are part of a loose building cluster at the centre of the complex. The composition of white parapets with different heights clearly refer to the surrounding Roche buildings. Both buildings use an architectural language dedicated to classic modern architecture, aiming for elegance with sparingly applied means.

Birskopfsteig Pedestrian Bridge Basel, Switzerland

length	76 m
building costs	1.5 Mio CHF
competition	2010, 1st prize
project	2010
construction	2011
client	Kanton Basel-Stadt



The river Birs near its estuary is a marginal location compared to the river Rhine and the close-by power plant which brand this recreational area. Therefore the new bridge is neither a suspension bridge nor an expensive framework, but rather a piece of path, a few metres of floating asphalt. The surface lifts off the ground and leads the walker, jogger or cyclist over the river on a gentle arc.

Pilgrim's Column Ruta del Peregrino Jalisco, Mexico

size	20 sqm
height	26.55 m
project	2008
construction	2011
client	Secretaria de Turismo Gobierno de Jalisco



The lookout point on the peak of the Cerro del Obispo, a mountain with almost 2,000 metres height, protrudes like a huge bone out of the woody landscape above the valley of Ameca. An organically shaped monolithic concrete column rises up to 27 metres. It can be entered from one side through a small entrance. Inside a unique view directly into the sky awaits the visitor. The light and the voice reflect on the concrete wall, providing a unique atmosphere.

Projects

Elisabethen Park Café Basel, Switzerland

size	140 sqm
building costs	1.08 Mio CHF
competition	2001, 1st prize
project	2001, 2010
construction	2010–2011
client	Kanton Basel-Stadt



The Elisabethenpark, a unique green space in the immediate proximity of Basel's main station, received an architectural face-lift and a landscape upgrade. The small 19th-century building at its periphery was transformed into a café. In order to improve its relation to the park, a big round opening was cut out in the southern wall. The circle lines up next to the other variously shaped openings and keeps the wall's structural integrity unharmed, as well as providing the structure with a modern generosity.

VoltaMitte Housing and Commercial Building Basel, Switzerland

size	16'000 sqm
building costs	48 Mio CHF
competition	2005, 1st prize
project	2005–2008
construction	2008–2010
client	Swiss Life



The new housing and commercial building in the North of Basel closes the triangular block between Voltaplatz and Lothringerplatz that came into existence after the construction of an underground motorway. The long building with retail and services on the ground floor and 92 apartments on the upper floors replaces the old housing development. It completes the traditional perimeter block development and thus creates a clearly defined urban situation. The volume of the building, distorted on the courtyard side, creates flats of varying spatial qualities with individual floor plans for each flat.

En Sully Residential Development La Tour-de-Peilz, Switzerland

size	31'600 sqm
feasibility study	2010, 1st prize
client	JdH Immobilier SA

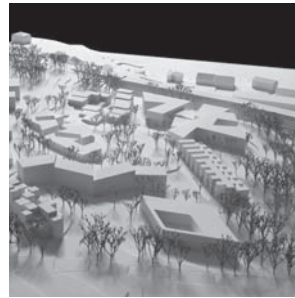

The residential development between Montreux and Vevey is composed of nine to eleven different houses with altogether about 210 apartments. The master plan envisions a composition of various buildings in a newly designed landscape. Following the principle of a garden city and kept free of cars, a green space extends over the complete terrain, thanks to the underground parking zone. A certain typology is designed for each house, depending on the orientation of its lot of land, and each house consists of apartments with 2.5 to 5.5 rooms. For the planning of these houses, eight young, international offices have been invited to develop one building each.

Schällemätteli Life Sciences Building University of Basel, Switzerland

size	51'540 sqm
competition	2010, 2nd prize
client	Kanton Basel-Stadt



The new teaching and research building is placed tangentially to the river Rhine. It refers spatially to the existing constellation of high-rise buildings in Basel. The new building creates a coherent system of university space together with the buildings in the vicinity. On the ground floor, the cafeteria is directly connected with the exterior, the two floors above accommodate the teaching rooms. The ten laboratory storeys expand from the fourth to the thirteenth floor and the first two levels are connected by an open staircase. The pillar-free rooms allow a maximum of flexibility and can be grouped together according to their usage.

WohnWerk Workshops and Housing Basel, Switzerland

size	6'400 sqm
building costs	20 Mio CHF
competition	2003, 1st prize
project	2006–2008
construction	2008–2010
client	Association Verein Jugendfürsorge



WohnWerk is a residential and working institution for disabled people. The housing and workshop buildings which replace the existing buildings transform the area at Missionsstrasse from an industrial backyard into a public space. The buildings are set in new situations along the street and in the courtyard. Their structure is designed in a highly pragmatic way and their dimensions are based on the layout of site. The resulting shape is the consequence of a systematic geometric moulding. New and highly varied spaces are created between the existing and the new houses.

Projects

Weltkulturen Museum Frankfurt am Main, Germany

size	7'497 sqm
competition	2010
client	City of Frankfurt on the Main



The Museum of the Cultures of the World needed an extension in order to show its rich collection as well as providing temporary exhibitions. Its complex concave geometry results from the distances between the roots of the garden's trees. The Corten-steel façade, which evokes a textile partition, is broken into fragments in order to avoid the massiveness of a plain wall within the garden. Hinting at a temporary construction, the volume rises on steel stilts to keep the transparency of the ground-floor level as well as the expanse of the public park. Inside, the curved walls subtly guide the movements of the visitors through the column-free spaces.

Swiss Church Renovation and Transformation London, England

size	450 sqm
building costs	3.4 Mio CHF
feasibility study	2006
project	2008
construction	2009–2010
client	The Swiss Church in London



Originally built in 1855 the Swiss Church in London required urgent renovation and spatial changes to adapt to current needs. The project mainly consists of enlarging the big hall by shortening a gallery from the 1950s and concentrating the new space towards the street end of the church. Moreover two new floors have been added. Thanks to this intervention, the big hall recovers its original elegant proportions. The organ is moved away from the front of the church and is shifted towards the middle of the main hall. The new structure provides space for offices, the parish working area as well as the organ gallery.

The Munch Museum and the Stenersen Museum Collections Oslo, Norway

size	12'300 sqm
competition	2009, 2nd prize
client	HAV Eiendom AS, in cooperation with Oslo Municipality



The existing urban situation on the river Akerselvas's estuary is transformed into a new cultural forum on the docks and at the same time into an inviting open space. The opera, the museum and the park bring the city to the fjord, like three fingers reaching for the seaside. The new museum offers a continuation of the promenade and – with its long volume lifted onto pillars and covered by a shed roof – reminds of past harbour architecture. It is raised above the ground as if to let the water flow underneath it.

Swiss National Museum Renovation, 1st phase Zurich, Switzerland

size	6'700 sqm
building costs	47 Mio CHF
competition	2002, 1st prize
project	2003–2005
construction	2005–2009
client	Schweizerische Eidgenossenschaft, represented by the Bundesamt für Bauten und Logistik



Since its opening in 1898, the Swiss National Museum has neither been substantially renovated nor enlarged. The reconstruction project includes spatial modifications as well as the addition of new elements, tying up to the architectural fabric already existing on site. It comprises an opulence of details and the commitment to specific materials used by Gull, the historic building's architect. Furthermore it evokes new and challenging views in correlation with the guarantee of recent technical and safety standards.

Baden Nord Office Towers Baden, Switzerland

size	50'000 sqm
competition	2009
client	ABB Immobilien AG



The ABB Office Towers are just slightly higher than the buildings in their vicinity and evoke, like the existing houses, a slight inclination towards the «inelegant». No «Baden Towers», no landmark buildings: although situated at the outskirts, they are completely anchored in the area, as a sculptural volume, as pragmatic architecture. The 1'200 sqm of floor-space are structured by recessed corners; they create different depths of rooms, interesting floor plan situations and a room quality that allows diversified office interiors.

Projects

Schaffhauserrheinweg Housing Building Basel, Switzerland

size	13'500 sqm
competition	2009, 3rd prize
client	Kanton Basel-Stadt



The project of remodeling Basel's former Children's Hospital into high-standard apartment buildings foresees two long houses with an internal garden courtyard. With the adjacent houses they form an urban block. The two apartment blocks, which follow the «Minergie» sustainability standard, produce spatial diversity thanks to the protrusions in their façades as well as their specific floor plans. Generous apartments are planned in the building, orientated towards the river Rhine on Schaffhauserrheinweg. Quoting the loggias, the balconies, the oriels of the neighbouring villas and the terraced houses, the new apartments offer individual and interesting spatial qualities and floor plans.

Mirror Garden House Residence, Ordos 100 Ordos, Inner Mongolia, China

size	1'065 sqm
direct assignment	
project	2008
client	Ordos Jiang Yuan Water Engineering Co. Ltd.

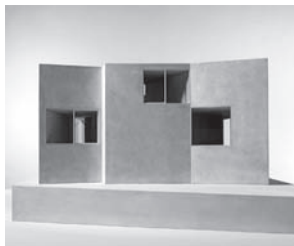

The project stages privacy in a dense urban settlement. At first glance a simple building, the «Mirror Garden House» is a surprisingly rich spatial system from the inside, offering unexpected relations of interior and exterior and creating a private and habitable labyrinth. From the outside, nothing reveals that the volume is an atrium house. The living space is organised around an inner courtyard, whose mirroring surfaces, similar to the external ones, give an appearance of infinity.

Dreispietz School of Art and Design Basel, Switzerland

size	28'000 sqm
competition	2007, 3rd Preis
client	Kanton Basel-Stadt



The new arts and design school building is the proud figurehead of Basel's Dreispietz district. It is organised within three different buildings: teaching and research occupy the new front building, studios and workshop spread in the former bonded warehouse, and the mensa is provided in Hall 16. The front building's higher volume, chamfered towards its ridge, keeps the width of the urban pattern characteristic of this area. However, its monumental cantilevering betrays its interest in formal gestures. The free-hanging corner is suspended from a framework incorporated into the building façade, and balanced by a similar feature at the diagonally opposite corner of the building.

Active Network Office Building Cheseaux-sur-Lausanne, Switzerland

size	24'288 sqm
competition	2008, 1st prize
client	Nagravision SA

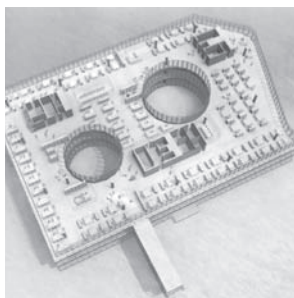

The Active Network building is designed as a generous open space, evoking the image of a wide landscape. Pillars afar from each other, flat slabs and generous span lengths allow versatile space and flexible room concepts for inspired and communicative working surroundings. The ground floor accommodates the restaurant for employees and the two upper floors provide room for the «open-space» landscapes, single and open-plan offices and as well as meeting rooms. Two round, leafy courtyards let in natural light and allow a seamless transition between interior and exterior.

Ancient Tree Pavilion Jinhua, China

size	200 sqm
project	2004–2005
construction	2006–2007
client	Jinhua City



The upswinging town of Jinhua in the hinterland of Shanghai is situated along a recently embanked river. Within the city lies a park, designed by artist Ai Weiwei and accentuated with 17 different pavilions. In this new and artificially created landscape stands a tree. An ancient tree by appearance. Cast from concrete, withstanding the weathers, old and gnarled, but offering shelter and a meeting space for people. The branches and leaves, all shaped in organic undulating forms, rather evoke an image of a plant than of a technical construction.

Projects

Residence and Indoor Swimming Pool Basel, Switzerland

direct assignment	
project	2005–2006
construction	2006



This project embraces the refurbishment of a family house of the 1930s into a guest house, including a hall for special occasions with up to 40 guests and a pool. The technical installations of a professional kitchen, as well as a ventilation and sound system have either been accommodated in the basement or integrated discretely into the interior fittings. Below the garden level an indoor pool with changing rooms, bathroom facilities and a steam bath has been integrated. The entire pool is made of two layered fair-faced concrete. The dramatic lighting situation creates the atmosphere of a grotto.

Friedensgasse Reconstruction and Extension Basel, Switzerland

size	320 sqm
direct assignment	
project	2005–2006
construction	2006



The house built in 1872 features an idyllic garden, surrounded by fire walls. The back of the house is now valorised by the extension of a third layer of rooms. Living with a view into the garden is made possible by the very high and studio-like living room, by the extension in length of the kitchen and by the veranda with two terraces. The annexes and the yard create a unity, the inside and outside interventions in dimensions, proportions, material and colour adjust themselves to the existing house. The new house thus represents a fusion of the existing and the extension.

Warehouse Transformation St. Alban-Vorstadt Basel, Switzerland

size	690 sqm
building costs	2 Mio CHF
direct assignment	
project	2004–2005
construction	2005–2006



This project comprises the renovation and modernisation of an old industrial building in the historic town of Basel. The aim of the project was to turn the sky-lit hall into an attractive work and living space by adding the necessary secondary rooms and infrastructure. The most obvious change is a small new building that re-stages the entrance to the hall and at the same time provides the modest industrial architecture with a new face. Framed through the neighbouring walls the façade shows an astonishingly strong presence in the rear courtyard, due to its simple composition with three openings.

Blätterdach Roof for a Schoolyard MuttENZ, Switzerland

size	320 sqm
building costs	320'000 CHF
competition	2004, 1st prize
project	2004
construction	2005
client	City of MuttENZ



A school in MuttENZ was provided with a roof construction to give pupils a sheltered space during breaks. The dense grove in the middle of the school yard turned out to be the perfect place for a canopied area. All trees are bordered with a gently curved roof which offers openings to the trees wherever necessary. Its round incisions recall a large oak leaf – turning the new roof into an artificial leafy canopy

Im Sesselacker Renovation and Transformation Basel, Switzerland

size	280 sqm
direct assignment	
project	2002–2003
construction	2003–2004



The «Im Sesselacker» house was built in 1957. In the course of its conversion and refurbishment it is liberated from its overly fragmented design and most of the interior walls are removed. Custom-made elements create new and open spaces, linking areas together and accommodating secondary rooms and cupboards. Rooms and spaces typical for the 1950s are reinterpreted in a contemporary manner. Colourful, shiny elements are introduced, including the ceiling of the living room being painted dark red. As a contrast to this interior world, the outside of the house is painted green and thus almost disappears in the luscious vegetation of the garden.

Projects

Residence Extension Arlesheim, Switzerland

size	140 sqm
direct assignment	
project	2000–2001
construction	2001–2002



The add-on to a traditional residential house built in the 1920s is designed as a garden shed. It is located in the midst of the landscape. Its large windows stage a view into the garden while the specifically designed wallpaper carries plants in terms of a huge picture into the residential quarters. The façade made of concrete is formed of corrugated fibre-cement panels and recalls modest summer houses. The wallpaper, wooden floor boards, fireplace, punch windows, and façade are made of traditional materials and, thus, in tune with the existing house, whose rooms were given back their original appearance by a careful renovation of the surfaces.

Torkelhaus Renovation Sargans, Switzerland

size	280 sqm
direct assignment	
project	1999–2000
construction	2001



The farm house, built after 1814 and located in the old town of Sargans, is almost preserved in its original condition. The interventions executed are meant to increase the level of comfort and convenience (baths, kitchen, access to the garden) and employ the materials and language of the existing architecture: stone floors, wooden windows without metal profiles and a wood stove. They recall the old and existing aspects or interpret them anew, as camouflaged, wallpapered doors to the bathroom and garden.

Studio House Zollikon, Switzerland

size	590 sqm
building costs	2.3 Mio CHF
direct assignment	
project	1998–2000
construction	2000–2001



The small house at the foot of a residential district beside the railroad is based on an anonymous, industrial and commercial type of architecture rather than on the villas in its proximity. The problematic railroad is interpreted as a plus and determines the atmosphere of the flats. A concrete frame, light-weight partition walls, and industrial flooring are the structural means to capture the character of commercial architecture. Each of the four flats has an individual outside space, either as a direct access to the garden or a generous roof terrace.

